



THE DRUM

W E M B L E Y



M E E T I N G S
•
C O N F E R E N C E S
•
E V E N T S

WELCOME

Set in the heart of vibrant Wembley Park, London, The Drum Conference and Events Centre offers unrivalled facilities capable of hosting a wide range of events from a small meeting for 10, to an extravagant function for over 800 guests.

Opened in 2013, The Drum is located in the Brent Civic Centre and is officially recognised as one of the most environmentally friendly public sector buildings in the United Kingdom and has received and 'outstanding' BREEAM accreditation.

All of our conference stationery including pens, notebooks and coasters are responsibly sourced to minimise environmental impact.



OUR SPACES

	Theatre	Reception	Classroom	Lunch or Dinner	Dinner Dance	Cabaret	Boardroom	Exhibition	Area	Height	Length	Width
Boardroom 1	22	Lunch or Dinner	6	18		16	12	-	30m2	3.2m	6m	6.1m
Boardroom 2	36	36	18	36	-	32	16	12	50m2	3.2m	8m	6.1m
Boardroom 3	30	18	10	18	-	16	12	4	40m2	3.2m	6m	6.1m
Boardroom 4	36	36	18	36	-	32	16	12	60ms	3.2m	8.3m	6.1m
Boardroom 5	36	36	18	36	-	32	16	12	60m2	3.2m	8.3m	6.1m
Boardroom 6	30	18	10	18	-	16	12	4	40m2	3.2m	6m	6.1m
Boardroom 7	36	36	18	36	-	32	16	12	50m2	3.2m	6m	6.1m
Boardroom 8	22	16	6	16	-	18	12	-	30m2	3.2m	6m	6.1m
Boardrooms 1 and 2	60	63	28	63	-	56	34	16	80m2	3.2m	14m	6.1m
Boardrooms 3 and 4	60	63	28	63	-	56	34	16	100m2	3.2m	14.3m	6.1m
Boardrooms 3,4 and 5	80	90	46	90	63	80	-	28	160m2	3.2m	22.6m	6.1m
Boardrooms 3,4,5 & 6	100	108	60	120	90	96	-	32	200m2	3.2m	28.6m	6.1m
Boardrooms 4 and 5	60	63	28	63	-	40	30	24	120m2	3.2m	16.6m	6.1m
Boardrooms 4, 5 and 6	80	90	38	90	63	80	-	28	160m2	3.2m	22.6m	6.1m
Boardrooms 5 and 6	60	63	32	63	-	56	26	16	100m2	3.2m	14.3m	6.1m
Boardrooms 7 and 8	60	52	24	52	-	56	34	16	80m2	3.2m	12m	6.1m
The Bridge	120	180	35	180	-	180	50	20	222.m2	6.92m	30.32m	7.33m
The Conference Hall	170	240	120	136	160	136	50	16	264m2	7m	15.95m	18.36m
The Grand Hall	750	850	90	450	400	450	-	50	539m2	6.88m	24.85m	26.2m
Winter Garden	100	350	-	120	120	96	-	14	-	7m	44.5m	14.5m
Olympic View	-	100	-	-	-	-	-	6	279m2	6.9m	30m	9.3m

Our modern-contemporary event spaces are split over three levels, all of which will inspire and excite you and your guests.

All spaces are fully accessible with direct lift access to all floors.

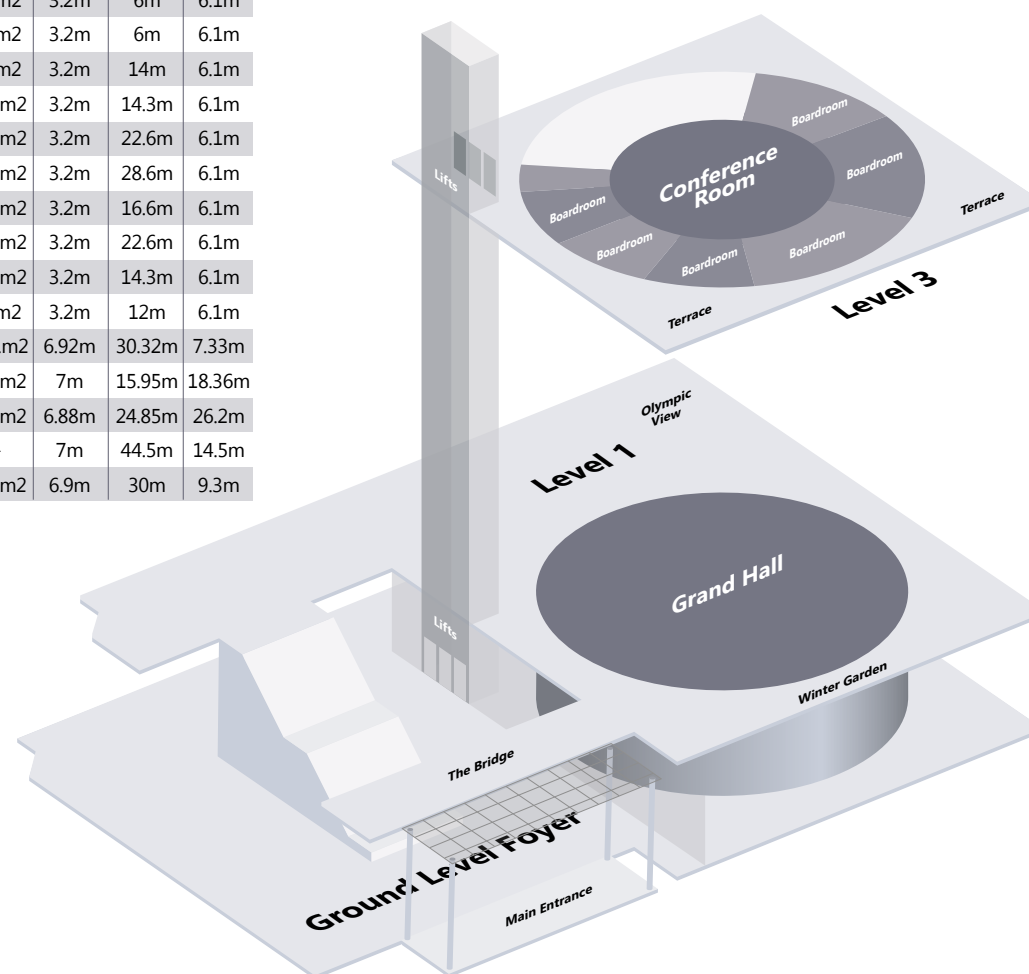

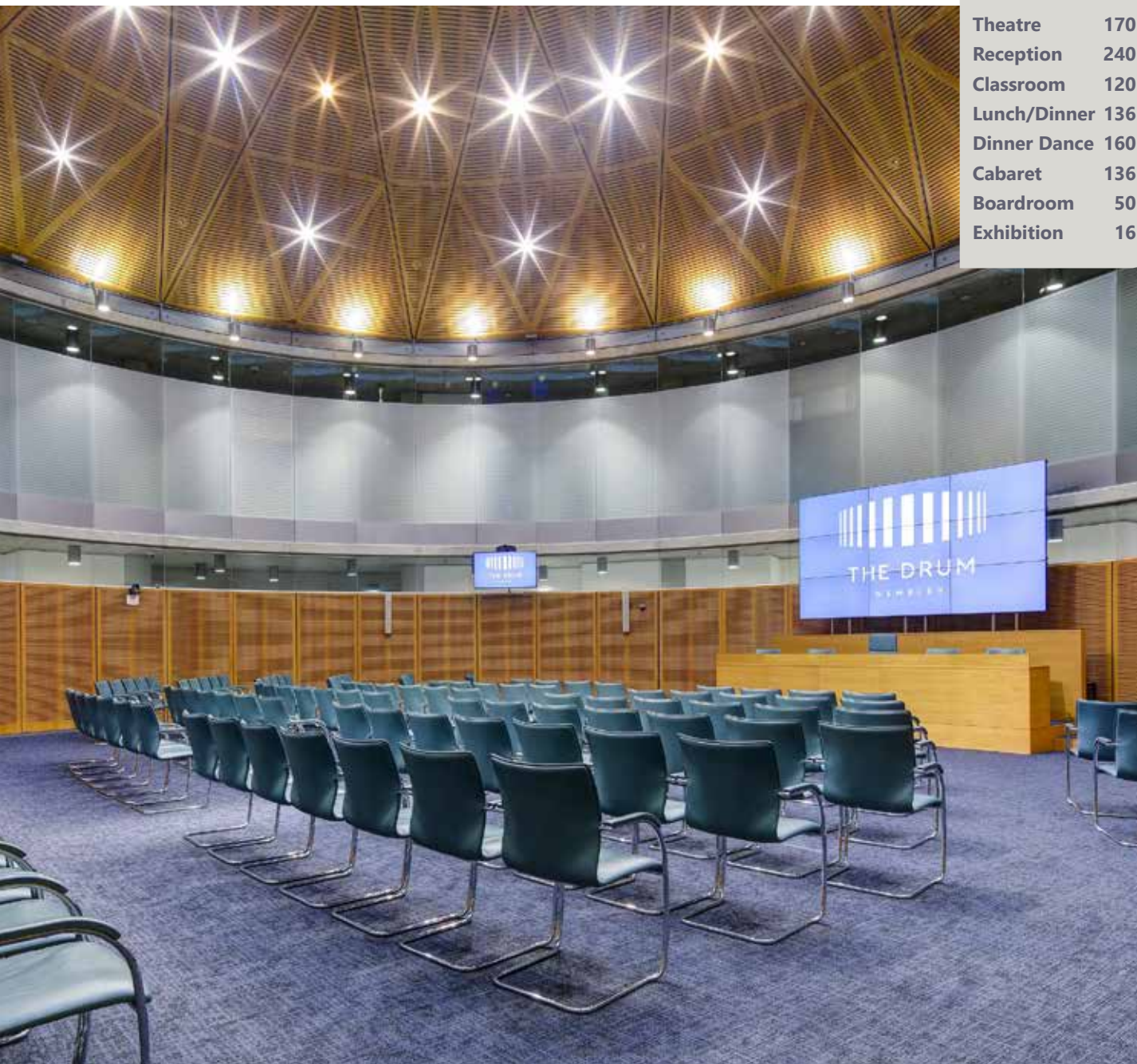

Theatre	170
Reception	240
Classroom	120
Lunch/Dinner	136
Dinner Dance	160
Cabaret	136
Boardroom	50
Exhibition	16

THE CONFERENCE HALL

By day The Conference Hall is flooded with natural light from a stunning glass lantern centrally located in the roof and can be hired with or without a large, digital display - great for presentations or film screenings.

The Conference Hall is suitable for conferences, exhibitions, product launches, filming, and larger meetings. The space can accommodate up to 150 guests depending on room layout.

Eight Boardrooms surround the Conference Hall and these offer maximum flexibility for events that require more space for meetings, breakout sessions, and workshops or just as additional space to compliment your event.



THE BOARDROOMS

Our boardrooms offer fantastic flexibility with the ability to connect up to four rooms thereby offering a flexible space accommodating any event from 8-100 guests.

These spaces are well suited to workshops, lunches, a press conference, broadcasting space or a simple meeting. Boardrooms compliment the use of the Conference Hall perfectly as they offer direct access from the space providing greater functionality for medium sized conferences or events.

Four of our boardrooms boast views of the Wembley Arch and Square and feature direct access to a vast outdoor terrace which is perfect for taking a break between meetings or during warmer months, can be used as an outdoor entertainment space.

All of our boardrooms are equipped with 65" screens with wireless connectivity for laptops and mobile devices resulting in a more efficient and professional experience.



BOARDROOM 1

Theatre	22
Reception	36
Classroom	18
Lunch/Dinner	18
Dinner Dance	-
Cabaret	16
Boardroom	12
Exhibition	-



BOARDROOM 2

Theatre	36
Reception	36
Classroom	18
Lunch/Dinner	36
Dinner Dance	-
Cabaret	32
Boardroom	16
Exhibition	12

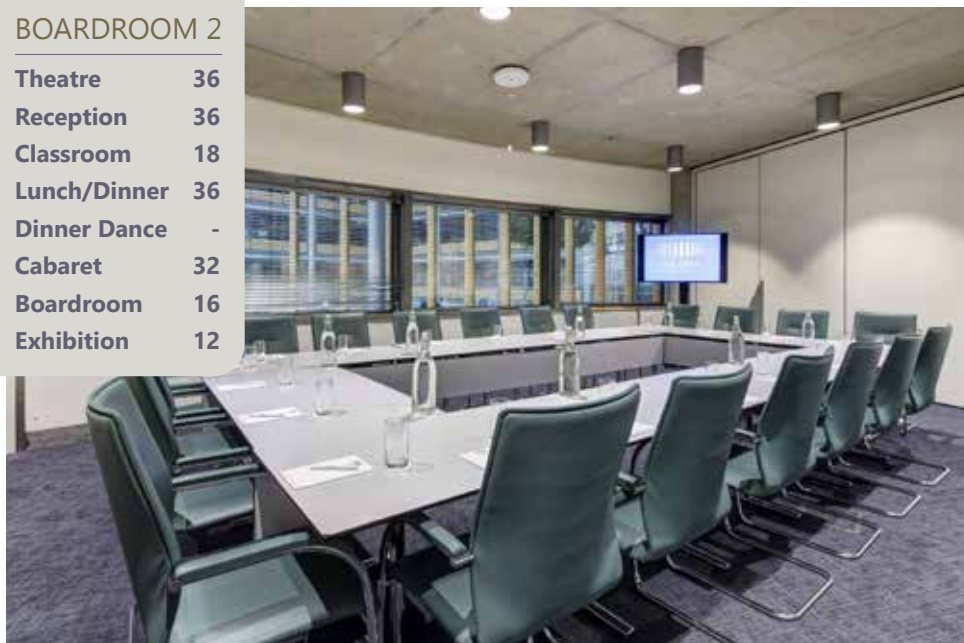

BOARDROOM 3

Theatre	30
Reception	18
Classroom	10
Lunch/Dinner	18
Dinner Dance	-
Cabaret	16
Boardroom	12
Exhibition	4

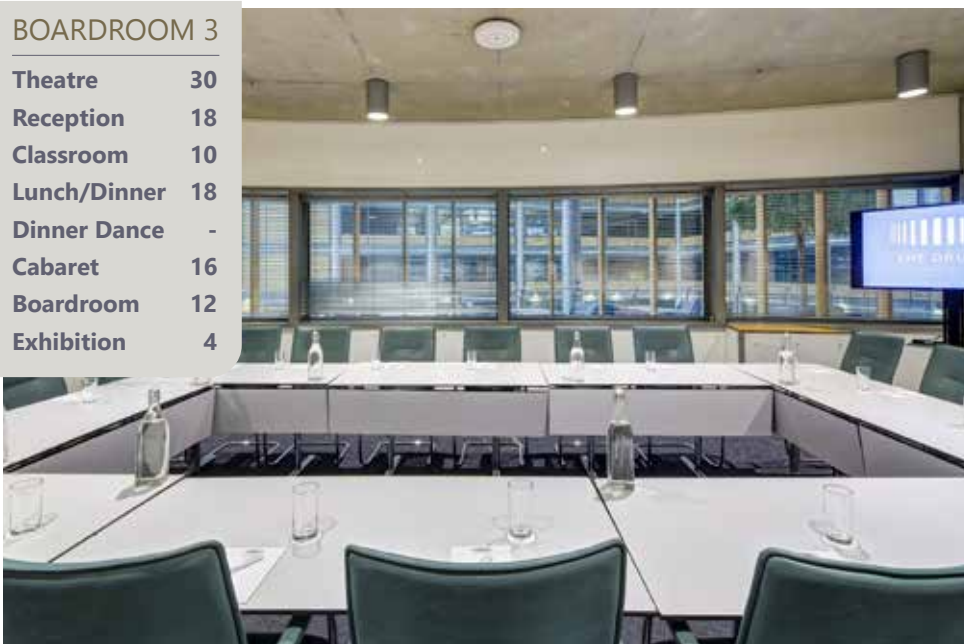

BOARDROOM 4

Theatre	36
Reception	36
Classroom	18
Lunch/Dinner	26
Dinner Dance	-
Cabaret	32
Boardroom	16
Exhibition	12



BOARDROOM 5

Theatre	36
Reception	36
Classroom	18
Lunch/Dinner	36
Dinner Dance	-
Cabaret	32
Boardroom	16
Exhibition	12

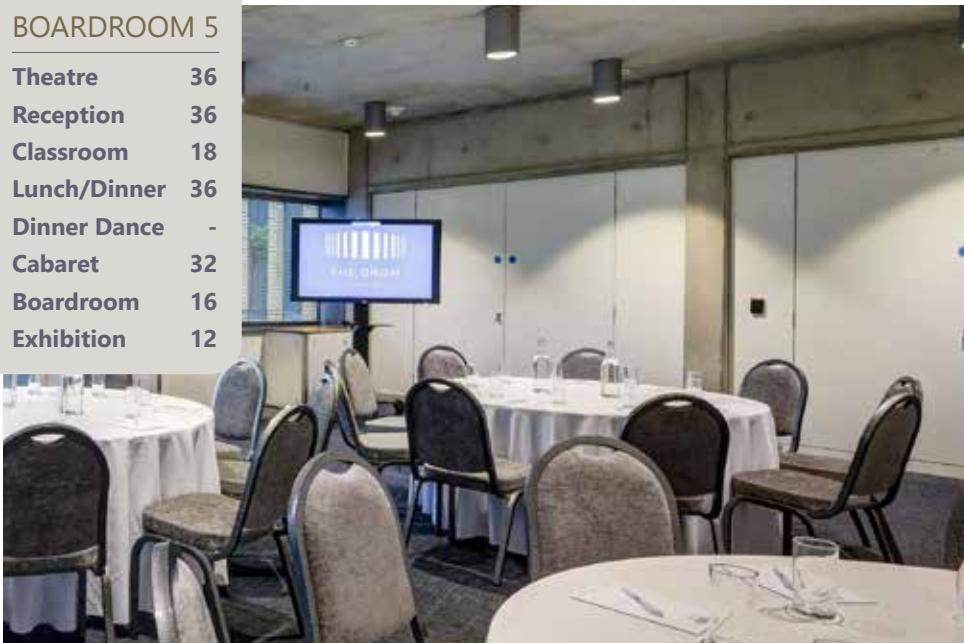

BOARDROOM 6

Theatre	30
Reception	18
Classroom	10
Lunch/Dinner	18
Dinner Dance	-
Cabaret	16
Boardroom	12
Exhibition	4



BOARDROOM 7

Theatre	36
Reception	36
Classroom	18
Lunch/Dinner	36
Dinner Dance	-
Cabaret	32
Boardroom	16
Exhibition	12

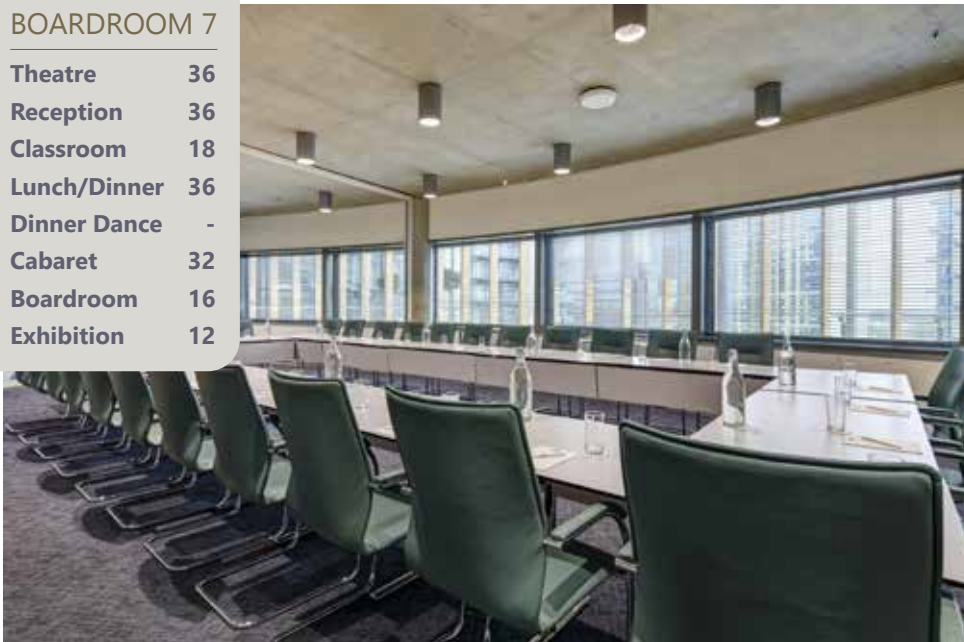

BOARDROOM 7

Theatre	22
Reception	16
Classroom	6
Lunch/Dinner	16
Dinner Dance	-
Cabaret	18
Boardroom	12
Exhibition	-

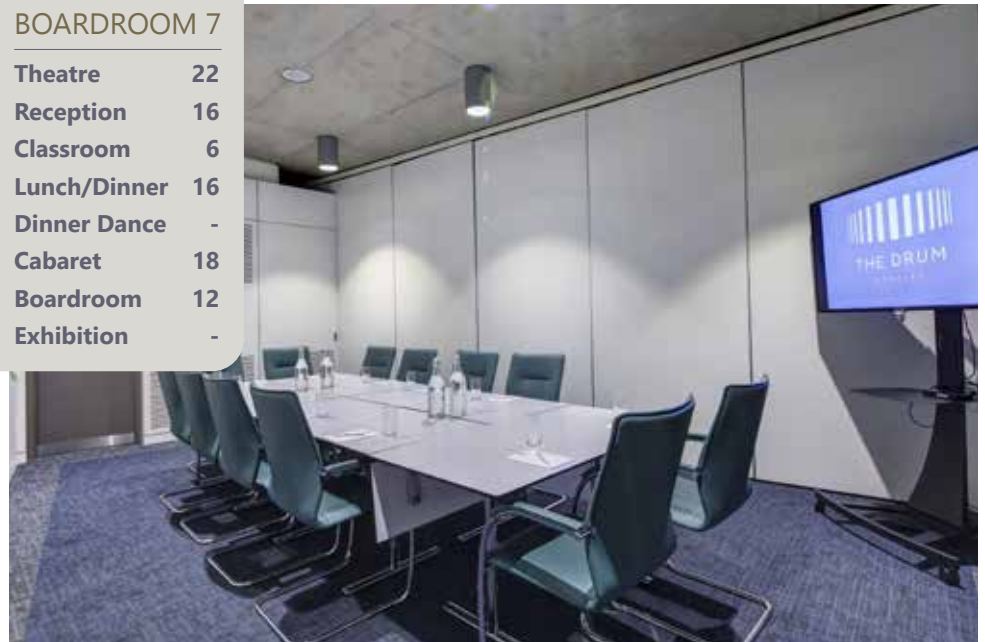



THE GRAND HALL

Our Grand Hall is a stunning, double-height circular space that lends itself to the imagination and creativity of you, the client.

Its flexible and spacious proportions are such that it can play host to a range of events from awards dinners, exhibitions and conferences to the most extravagant of weddings.

The hall benefits from natural daylight but can also be fully darkened for presentations and screenings. Staging can be located anywhere within the space - offering multiple layout options.

If more space is required, the adjoining Winter Garden offers further options and provides plenty of natural daylight in a beautiful serene area featuring planted trees.

In addition to the Winter Garden, Olympic View and The Bridge spaces can be hired in conjunction with The Grand Hall (or individually) thereby offering significantly more event space.

The ability to hire these spaces independently or together means the first floor of The Drum is a highly flexible event space that is suitable for almost any event for up to 850 guests.

Theatre	750
Reception	850
Classroom	90
Lunch/Dinner	450
Dinner Dance	400
Cabaret	450
Boardroom	-
Exhibition	50

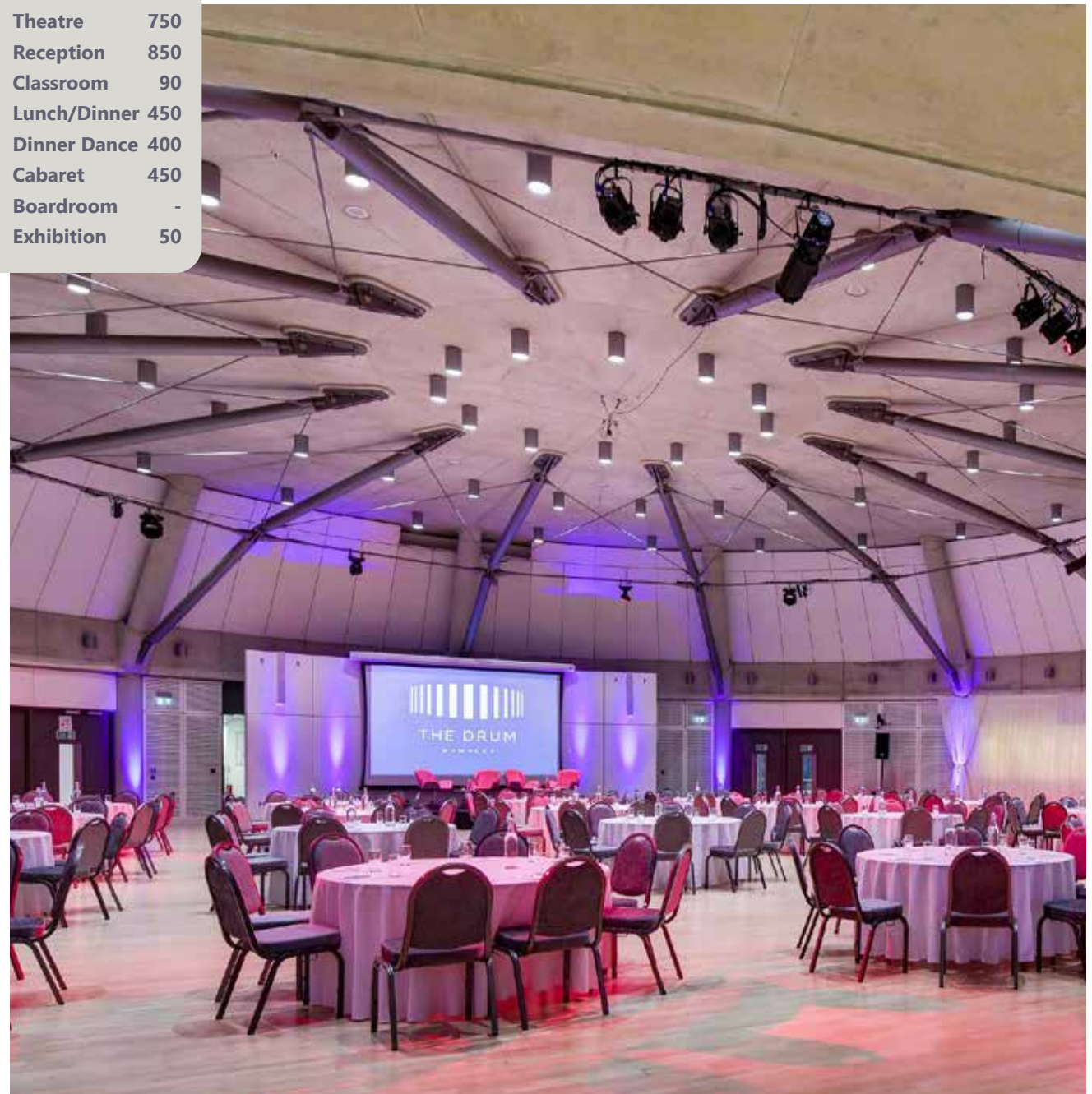

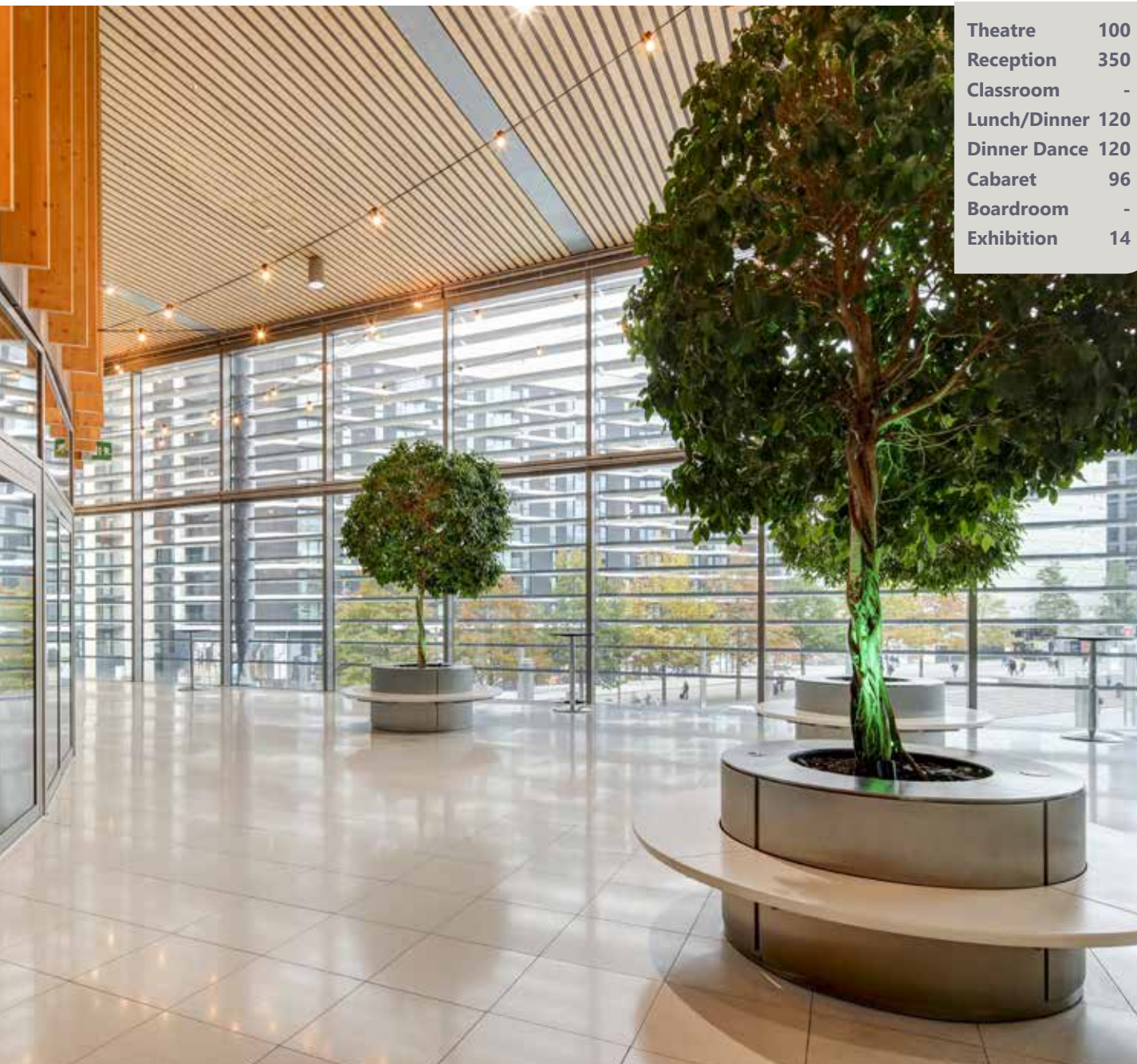

THE WINTER GARDEN

The Winter Garden is a double-height space that majestically wraps around the south and east portion of The Drum. The space benefits from breathtaking views from its floor to ceiling windows.

The space is a fully enclosed, all-weather space and is ideal for networking events, exhibitions, pre-dinner drinks receptions or providing pre-event hospitality for the nearby Wembley Stadium and Wembley Arena.

The space can also be used to compliment larger events that are hosted in the adjoining Grand Hall - providing greater flexibility and capacity options.

Large trees with seating at the base provide greenery and atmosphere in this light and airy space, and the white marble flooring adds a touch of elegance - making it a space you can make your own.

Theatre	100
Reception	350
Exhibition	15



THE BRIDGE

The Bridge is perfect for smaller fairs or markets, sample sales events, or as an additional space to complement The Grand Hall, Winter Garden and Olympic View spaces.

With floor to ceiling windows and bursting with natural light, this is an open and welcoming space. It can host 20-160 guests depending on the type of event held.

The Bridge overlooks both The Atrium space and features the Wembley Arch as a backdrop and the Wembley Area and Square below.

Theatre	120
Reception	180
Classroom	35
Lunch/Dinner	180
Dinner Dance	-
Cabaret	180
Boardroom	50
Exhibition	20





THE ATRIUM

As you enter the building, you are greeted by the magnificent Atrium space which soars upwards and is topped by a spectacular bubble roof six levels above.

The space is flooded with lots of natural light and the grand staircase doubles as amphitheatre seating from which audiences can view a variety of events taking place on the sweeping marble floor below.

The Bar, Melting Pot cafe and The Bridge on the first floor above The Atrium provide additional informal seating with vantage points of the foyer.

The foyer offers a great setting for displays, exhibitions, product launches, drama, music, dance or informal receptions.

Performance	200
Exhibition	5



THE PAUL DAISLEY GARDEN

Manicured gardens can add a different dimension to your event. Featuring a walled garden with pleached trees and a canopied seating area, The Paul Daisley Garden is an ideal space for guests to take business lunch and enjoy the tranquil space in between meetings or a space to entertain.

Theatre	150
Reception	150
Lunch/Dinner	80



AUDIO VISUAL SERVICES

Our in-house AV service offers a wide range of AV equipment backed up with fully trained technicians for events held at The Drum.

AV technicians can cater for all types of events - ranging from simple requests such as providing a laptop and presentation clicker for a meeting to providing a full hybrid event equipment package.

We know that AV is crucial to the success of an event and our AV technicians and staff will recommend technical and creative ideas to enhance your event further whilst maximising your budget.



GETTING TO THE DRUM WEMBLEY

By tube

The Drum is just five minutes' walk from Wembley Park Tube Station, which is serviced by the Jubilee and Metropolitan lines and is in Zone 4. Wembley Stadium is also a 5 minutes' walk and services operate from this station to Marylebone with Chiltern Railways.

By bus

The 83, 483, 92, 182 and 206 buses all stop a short walk from the building and run frequently.

Mainline railways stations

Kings Cross 24 minutes

Paddington 21 minutes

Marylebone 18 minutes

Victoria 27 minutes

Waterloo 22 minutes

By road

M25 and A1 main roads 20 minutes

A406 main road 10 minutes

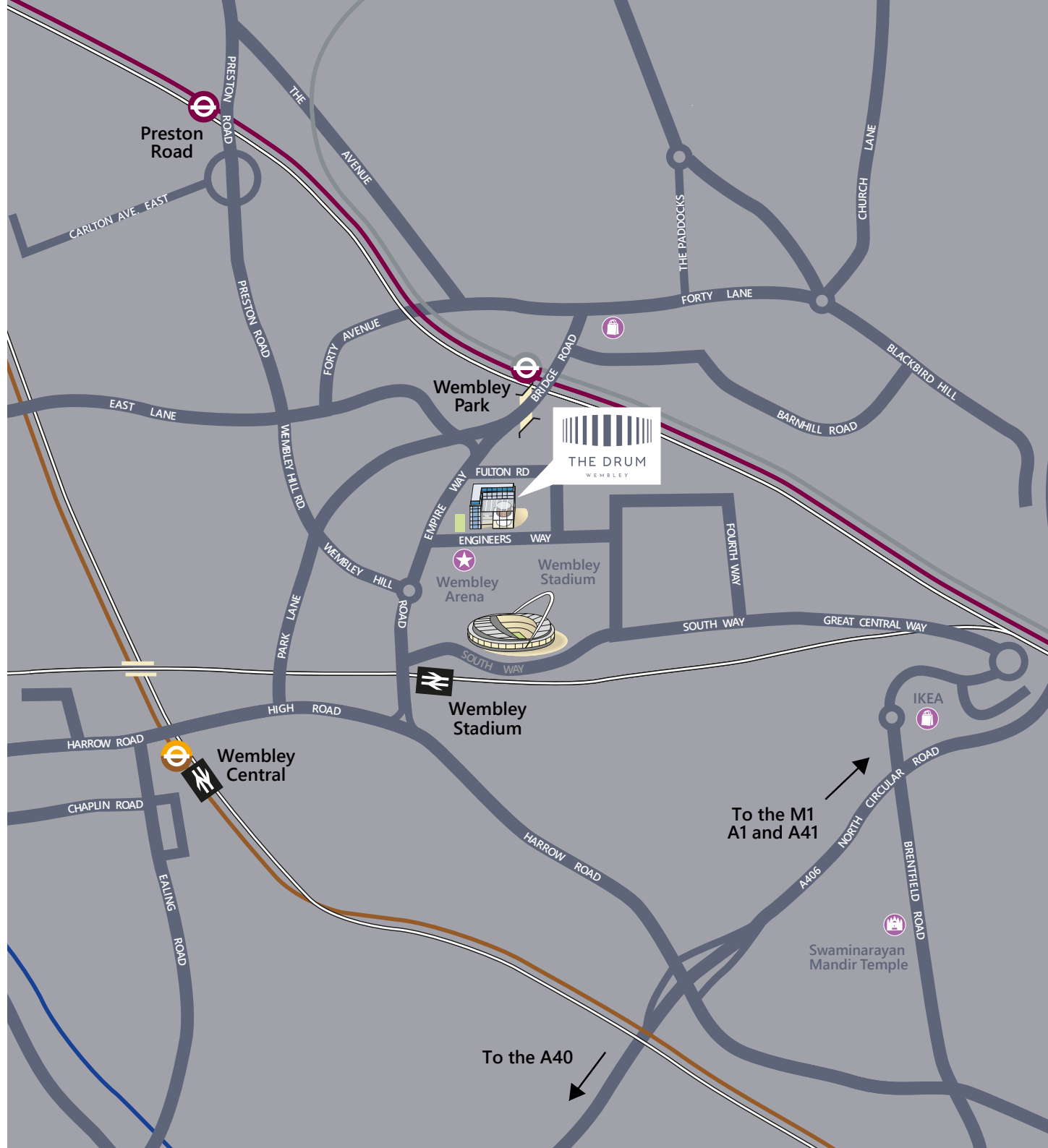

THE DRUM WEMBLEY HIGHLIGHTS

14 stunning modern-contemporary flexible events spaces

Conference and Events Team with over 25 years' experience

All spaces within The Drum benefit from natural daylight

80 on-site parking spaces (subject to availability)

Hundreds of parking spaces all within a 10-minute walk

Only 20 minutes from central London

Hundreds of quality hotel rooms all within a 5-minute walk

In-house AV Team

Complimentary WiFi

Dedicated Events and Operations Team

Fully equipped professional kitchen facilities

Licensed bar

A wide range of restaurants, shops and entertainment venues just a moments' walk away

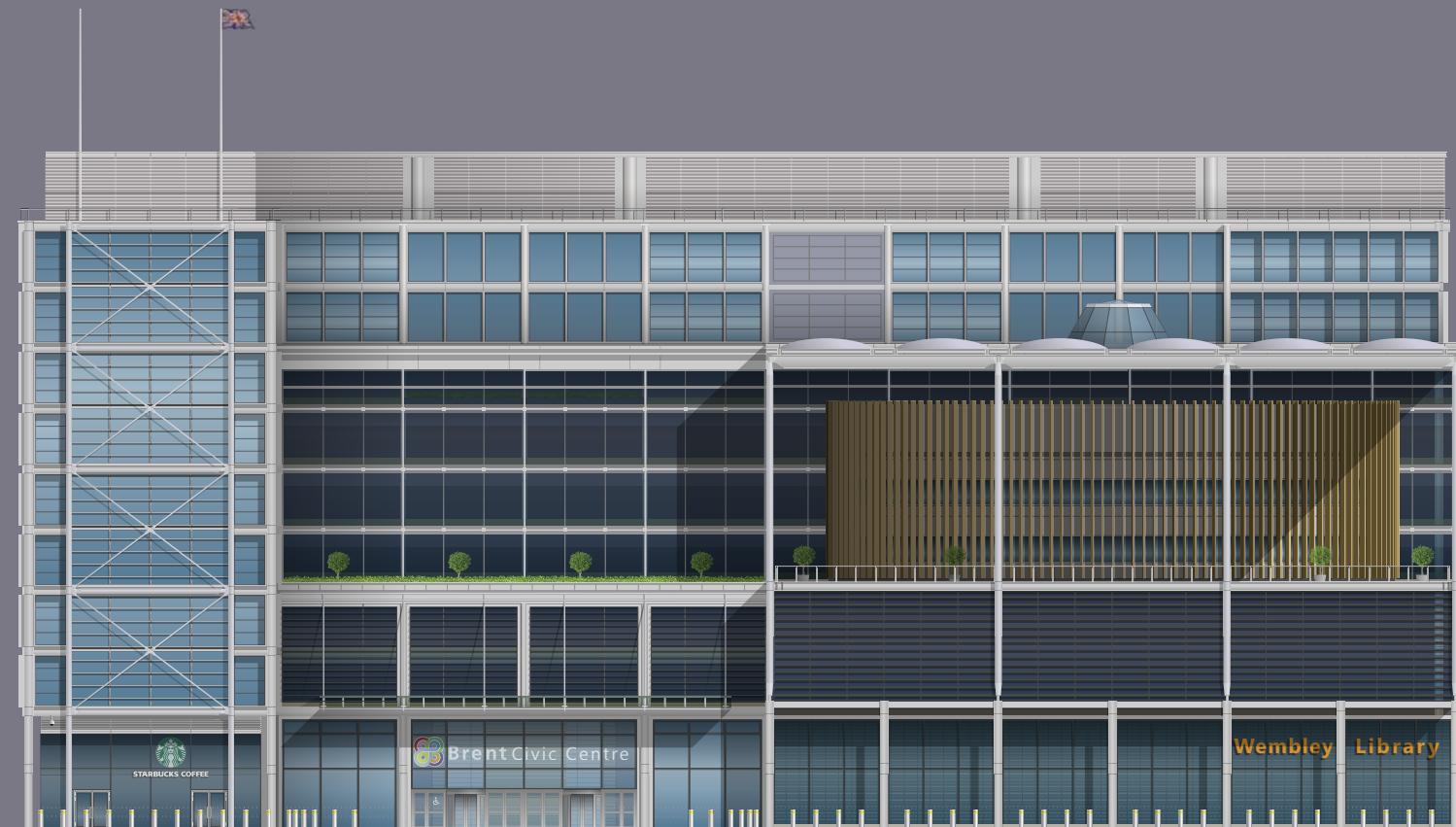



THE DRUM

W E M B L E Y

www.thedrumwembley.com



@drumwembley



@drumwembley



@drumwembley



The Drum Wembley